

HA-6400 Côr™ Home Automation System Setup Guide



Technical Supplement

SUMMARY

The following supplemental instructions will provide a repeatable best practices in setting up the Côr Home Automation system. In addition, you can reference aspects of this document about installing and setting up the Côr Home Automation Starter Kit.

BENEFITS

- Reduces installation time in the home so that you can focus on more time walking the homeowner through their new system that you just installed
- Build homeowner confidence with the installer since issues that may be experienced during initial system setup can be addressed in the office versus in the home

NEEDED FOR THIS SETUP

- Côr Home Automation Smart Start Kit (HA-6400-KIT-S)
- Connected Wi-Fi network router with Ethernet cable
- Laptop or Desktop Computer with web browser access



Step 1 — Connect Power to the Côr panel

- Connect power to the back of the panel using the transformer adapter
Pro Tip: Order an extra transformer adapter (part number ZW-PS9V) that can be used for the setup and leave the one in the package intact.

Step 2 — Establish a network connection to the panel for firmware update

- Connect the Ethernet cable from your primary router to the Ethernet port on the back of the Côr panel.
- Confirm the Côr panel is using Ethernet (and not Wi-Fi)

1. **MENU** **9**
2. **INSTALLER CODE** **ENTER**
3. **7**

- If panel says, "Press 7 to switch to Ethernet" then Press **7**, otherwise proceed to verify the IP address

4. **MENU** **8**
5. **6** IP Address is...

If the Côr panel announces "*IP is not ready*", check your network connection to make sure it is not on a firewall or VPN network. For example, can you get to the internet if you plug in a random computer?

Step 3 — Provision the Côt panel on the UltraSync Dealer Portal

- Launch your web browser and login to <https://webportal.ultra-sync.com>
- Click on the + “plus” icon next to the Search field at the top to add a **New Site** and enter the requested information to provision the panel to the customer

Central station
Self Monitoring ← Leave as **Self Monitoring**

Name
Stapinski Shawn ← Use Last Name, First Name

Address
111 Front st
Country United States
Hawaii
City Hona
ZIP 58821
Phone 44075 ← Enter homeowner address information

Mobile
SID 258904578946 ← Enter 12 digit Serial Number located on the back of the Côt panel. Make sure to correctly enter the number.

Timezone
America/New_York

VFN
SELFMON ← Leave as **SELFMON**

Account
1234 ← Create a 4 digit number as the account for the homeowner i.e. 0001

Format
System Default ← Leave as **System Default**

Service Grade
US IP ← Select **US IP**

Video Verification (BETA) (VV) ← Do not select

Create **Cancel**

Click **Create** when finished.

A180144

Step 4 — Update the Côt panel with the latest Firmware

- On the UltraSync Dealer Portal, click on the 3 line 'hamburger' icon at the top left corner of the screen
- When the menu expands on the left side of the screen, click on **Operational Status** to display all the panels on your portal

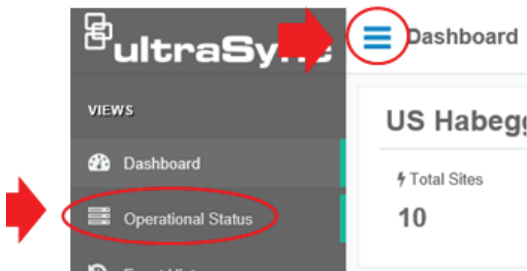

Panels that are communicating with the internet will be shown in **GREEN**, panels on the cloud not communicating with the internet will be shown in **RED**. Panels that have never been connected to the internet will be shown in **GRAY**.

- Locate the panel provisioned in Step 4 and click on the **Retrieve Live Status** “Globe” icon to the right
- Click on the **Update** icon when available on the bottom left side of the screen (if the Update button does not appear, go back to the previous screen and enter the Retrieve Live Status “Globe” again)

Valley view	Ohio	44125	United States	875994069888	SC Hub	A58P002009-30		
Valley view	Ohio	44125	United States	583688418495				
Valley view	Ohio	44125	United States	627981978232				
Valley view	Ohio	44125	United States	486692227677	SC Hub	A58P002009-30		



- In the popup menu, select the latest firmware version at the top
- Check the box for **Auto Activate** and click **Update**

NOTE: The latest firmware version will always be listed at the top of the pop up window and designated with a higher Service Release number.

- Stay on this screen to perform the next *optional* steps to pre-configure the Starter Kit sensors and Z-Wave module in the office.

A180148

Step 5 — Login to the Côt Panel from the UltraSync Portal to setup Smart Starter Kit Sensors and Z-Wave Light Dimmer Module

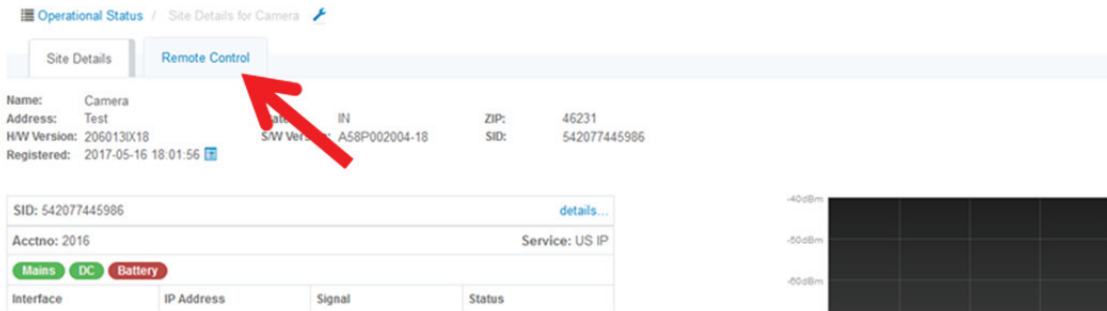

A180149

- Click on the *Remote Control* tab on the left side of the screen
- Sign in as an installer
 - Username: **installer** (lower case)
 - Password: **9713**
 - Click on **Settings > Sensors** under the *Settings Selector* drop down menu items

NOTE: The Côt panel will automatically power cycle once the firmware download is completed and you may need to login again while performing the setup process below.

Pro Tip: Install the 24 battery backup into the back of the Côt panel after you are done and begin to place the items back in the Smart Starter Kit box.

Prepare the Sensors and Z-Wave Light Dimmer for installation

- (3) **TX-E201** (previously TX-1012-01-1) **Door/Window Sensor**
 - Remove sensor from packaging
 - Use a marker or place a label on each Sensor that identifies their location i.e. Front Door
 - Remove the main body from the cover and gently insert the lithium battery in the battery compartment being careful not to press the black tamper button in the middle
 - Leave the cover off at this time
- (1) **60-807-95R Motion Sensor**
 - Remove from packaging
- (1) **60-744-95R Water Sensor** (some newer Starter Kits may have the **TX-E611**)
 - Remove from packaging
- (1) **IS-ZW-LM-1 Z-Wave Light Dimmer**
 - Plug Light Dimmer into a nearby power outlet

Setup instructions for other Add-On components that are not included in the Smart Starter Kit are available in **Appendix A** on the back pages of this document. This includes:

- Smoke Detector (319.5 MHz)
- CO Detector (319.5 MHz)
- Firefighter Audio Detector (319.5 MHz)
- Glass Break Sensor (319.5 MHz)
- Garage Door Tilt Sensor (319.5 MHz)
- Key Fob (319.5 MHz)
- Secondary Touchscreen Panel (Wi-Fi)
- 319.5 MHz Repeater (part # 80-922-1)

Learn the TX-E201 Door Window Sensors to the Côt panel



While sensors can be learned in any order, the next few pages are shown in the order they are learned.

- Go to **Settings** and select **Sensors** from the dropdown menu under Settings Selector
- Click on the **Learn** button
- Pick up one of the TX-E201 Door Window Sensor main body with the inserted battery and press the exposed black tamper button. Place cover over the main body ('TOP' arrow is opposite of battery side) and snap in place
- A message will appear that a New Device Found

The screenshot shows the 'Settings Selector' interface. At the top, there is a dropdown menu set to 'Sensors' and a 'Save' button. Below this is a section for 'Sensor Add/Remove Functions' with a 'Remove' button. The main configuration area includes:

- 'Select Sensor to Configure:' dropdown set to '1 Front door'
- 'Sensor Name' text field containing 'Front door'
- 'Sensor Type' dropdown set to '3 Entry Exit Delay 1'
- 'Sensor Options' dropdown set to '1 Bypass'
- 'Area Group' dropdown set to '1 Area 1'
- 'Serial Number' text field containing 'ACB7DC'
- 'Tamper' checkbox checked
- 'Disable Internal Reed', 'Norm Open External Contact', and 'Disable Supervision' checkboxes unchecked
- 'Voice Name 1' dropdown set to 'FRONT'
- 'Voice Name 2' dropdown set to 'DOOR'
- 'Voice Name 3' and 'Voice Name 4' dropdowns are empty

Name the Sensor

Select **Entry Exit Delay 1** or **Instant** (typically used for unlikely entry point i.e. windows)

Select **Bypass** under Sensor Option

Leave as **Tamper**

Name the sensor for the panel voice annunciation

Click **Save** at the top when finished

A180151

Repeat step for the next (2) TX-E201 Door Window Sensor

- Select **Sensor to Configure** for the next available slot i.e. “2 Sensor” and “3 Sensor”
Make sure not to select the previous sensor as this will override the settings.
- Click on the **Learn** button and repeat steps as above

This screenshot shows the 'Settings Selector' interface with the 'Learn' button highlighted in a red box. The 'Sensor Add/Remove Functions' section shows 'Learn' and 'Cancel' buttons, with 'Learn' also highlighted. Below, the 'Select Sensor to Configure:' dropdown is set to '2 Sensor', which is also highlighted in a red box. A red arrow points from the 'Learn' button to the '2 Sensor' dropdown.

A180152

Learn the 60-807-95R Motion Sensor to the Côt Panel



A180155

- Select **Sensor to Configure** for the next available slot i.e. “4 Sensor”
- Click on the **Learn** button
- Remove the back cover from the Motion Sensor
- A message will appear that a New Device Found

A180153

Name the sensor

Select **Follower**

Select **Bypass Stay** under Sensor Option

Leave as **Tamper**

Name the sensor for the panel voice annunciation

Click **Save** at the top when finished

A180154

Learn the 60-744-95R Water Sensor to the Côr Panel



A180164

- Select **Sensor to Configure** for the next available slot i.e. “5 Sensor”
- Click on the **Learn** button
- Remove the top cover from the Water Sensor main body and press the program button on top of the sensor main body
- A message will appear that a New Device Found

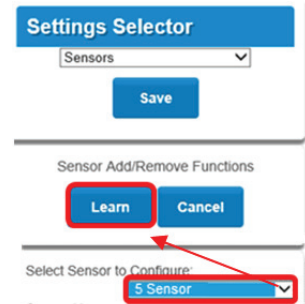

A180156

Name the sensor

Select **24 Hour Audible**

Select **Water Leakage** under Sensor Option

Leave as **Tamper**

Check **Disable Internal Reed**

Name the sensor for the panel voice annunciation

Click **Save** at the top when finished

A180157

Confirm Water Sensor is properly sync'd with the Côr Panel

- Short the contacts on the small Water Sensor unit with a metallic pin
- The Côr panel will alarm or chirp
- Acknowledge the alarm by entering **1 2 3 4 > Enter** to silence the panel
- Repeat two more times

Learn the TX-E611 Water/Freeze Sensor to the Côt Panel (if included in Starter Kit)

NOTE: In this setup, the sensor will be learned into the system as a Water and a Freeze sensor.



A180159

Learn as a Water Sensor

- Select **Sensor to Configure** for the next available slot i.e. “5 Sensor”
- Click on the **Learn** button

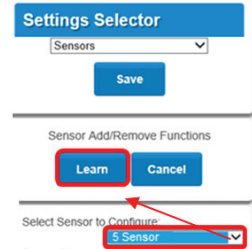

A180158

- **TAP** a magnet (i.e. from a Door/Window Sensor) to the vertical line mark on the side of the TX-E611 Sensor
- A message will appear that a New Device Found



A180160

Settings Selector

Sensors

Save

Sensor Add/Remove Functions

Learn Cancel

Transmitter Type

Select Sensor to Configure:

Sensor Name

Sensor Type

Sensor Options

Area Group

Serial Number

Tamper

Disable Internal Reed

Norm Open External Contact

Disable Supervision

Voice Name 1

Voice Name 2

Voice Name 3

Name the sensor

Select **24 Hour Audible**

Select **Water Leakage** under Sensor Option

Leave as Tamper

DO NOT CHECK Disable Internal Reed

Name the sensor for the panel voice annunciation

Click **Save** at the top when finished

A180161

Learn as a Freeze Sensor

- Select **Sensor to Configure** for the next available slot i.e. “6 Sensor”
- Click on the **Learn** button
- **HOLD** a magnet (i.e. from a Door/Window Sensor) for at least **2 seconds** to the vertical line mark on the side of the TX-E611 Sensor
- A message will appear that a New Device Found



A180160

Sensor Name
Freeze Detection

Sensor Type
2 24 Hour Audible

Sensor Options
13 Low Temp

Area Group
1 Area 1

Serial Number
0ACC2C4

Tamper

Disable Internal Reed

Mount Case External Contact

Same parameters as above except *Sensor Option* is Low Temp.

A180163

Settings Selector

Sensors

Save

Sensor Add/Remove Functions

Learn Cancel

Select Sensor to Configure

6 Sensor

A180162

Confirm Water Sensor is properly sync'd with the Côr Panel

- Short the contacts on the small Water Sensor unit with a metallic pin
- The Côr panel will alarm or chirp
- Acknowledge the alarm by entering **1 2 3 4 >**
ENTER to silence the panel
- Repeat two more times

Learn the IS-ZW-LM-1 Z-Wave Light Dimmer to the C r Panel



The steps in adding Z-Wave™ devices are all the same. This includes items such as light modules, light switches, door locks, garage door controllers, etc.

Typically, Z-Wave devices that will work with the C r Home Automation system are items that can allow you to Open or Close and Turn On or Off. So while a “Z-Wave Door Window Sensor” can be setup with the steps below, the sensor will not display in the C r Home Automation app.

- Go to **Settings** and select **Zwave Add/Remove** from the dropdown menu under Settings Selector

Pro Tip: Remove the Z-Wave device first since some devices may have been tested prior to shipment from the manufacturer.

Settings Selector

Z-Wave Add/Remove

Save

Device Add/Remove Functions

Add Remove Cancel

Include

Z-Wave Device Selector

(1) Alarm System

Removed Device 0.
Select a device to Edit Names Or Click
A Function Above

Device Room Location

Room 1

Device Name:

Tick For High Power Add Option

A180166

Click the **Remove** button

Press the center button repeatedly on the Z-Wave device

The status display under the *Z-Wave Device Selector* field when the panel finds the device

Settings Selector

Z-Wave Add/Remove

Save

Device Add/Remove Functions

Add Remove Cancel

Include

Z-Wave Device Selector

(7) Light Dimmer Switch

Added Device 7
Light Dimmer Switch.
Enter Location Name and Device Name

Device Room Location

Room 1

Device Name:

Tick For High Power Add Option

A180167

Click the **Add** button

Press the center button repeatedly on the Z-Wave device

The status display under the *Z-Wave Device Selector* field when the panel finds the device

Name the Z-Wave Control Device

Click **Save** at the top when finished

AT THE HOME

The following steps will show you how to complete the final process of setting up the Côr Home Automation system.

NOTE: This setup will require the Côr panel to be provisioned (Step 3) and updated with the latest firmware S.R. 4.1 or higher (Step 4).

Needed for this setup

- Côr Home Automation Starter Kit
- Homeowner smartphone or tablet device
- Homeowner internet credentials (optional)

Step 6 — Download and setup on Homeowner's Smartphone or Tablet Device

- Install the 24 hour battery backup in the back of the Côr panel (if not previously done) and plug the transformer power supply from the Côr panel into an electrical outlet.
- Ask the homeowner to download the Côr Home Automation app from iOS App Store or Google Play Store.
- Launch the app and follow the guided directions



Click on the "Hamburger" menu.

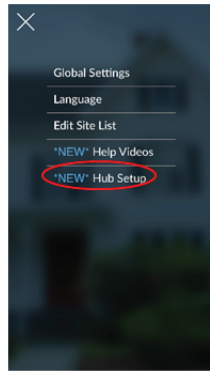

Click "New" Hub Setup

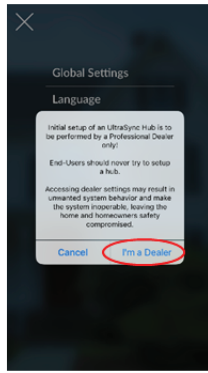

Click I'm a Dealer.

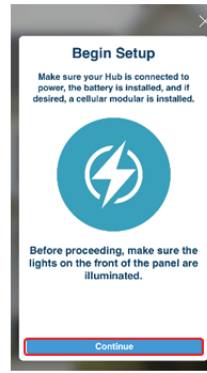

Click Continue.

Skip the screen about provisioning and updating the firmware to the Côr panel since this was done in Steps 1-4. Continue to follow the instructions on the screen including enabling Wi-Fi Discovery Mode on the Côr panel.



Select homeowner Wi-Fi network if not using an Ethernet connection directly to the Côr panel. Click **Continue**.

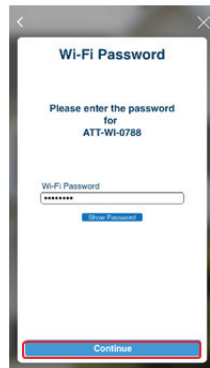

Have homeowner enter their Wi-Fi password. Click **Continue**.

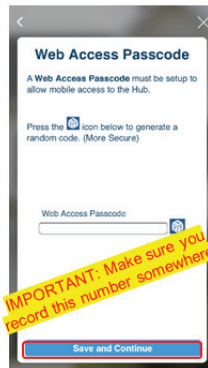

Enter an 8 digit Web Access Passcode i.e. 12345678. Click **Continue**.

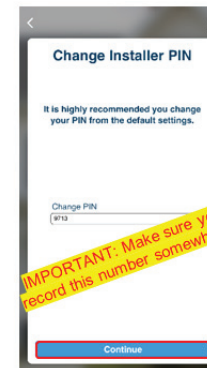

Change installer PIN. Click **Continue**.

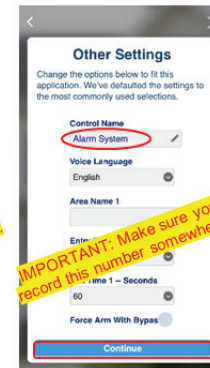

Change the Control Name if desired i.e. Home. Also, change the Download Access Code at the bottom. Click **Continue**.

A180169

Step 7 — Login the Côt Home Automation app to setup Sensors, Z-Wave devices, and UltraSync IP Cameras

IF additional add-on components are needed, reference the *Sensor and Z-Wave* device setup in **Step 5**. Otherwise, previous in-office sensor and component programming from Step 5 are still saved in the Côt panel and **NO** additional setup is required.

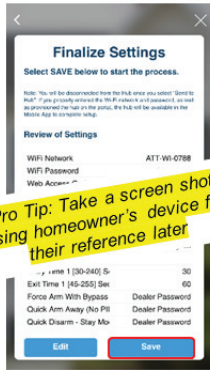

Click Save.

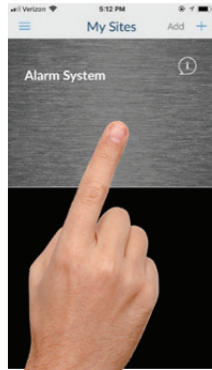

Click on the “Hamburger” menu.

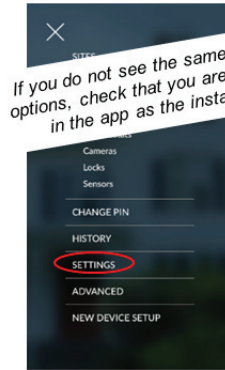
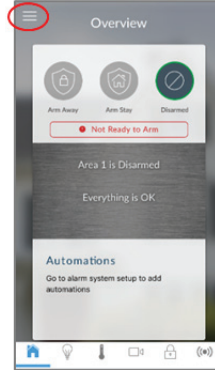

Click SETTINGS to setup Sensors and Z-Wave devices.

A180170

Place the Sensors and Z-Wave devices in the desired locations.

***Performing a 'Walk Test' is critical and should be performed on every installation prior to leaving the job site.

Walk Test on the Côt Hub

Performing a Walk Test on a Côt Hub is seamless. From the Hamburger menu select **Settings > Walk Test**, then click **Start Walk Test**. Follow the Walk Test instructions as prompted on the app.

The **Result** rating that is display is based on the lowest score achieved in any of the categories. **In order to prevent communication errors, when a Result rating of Poor or Fair is received, it is recommended to adjust the installation of the sensor.**

	Trigger		Restoral	
	Minimum Packets	Signal to Noise Floor Delta	Minimum Packets	Signal to Noise Floor Delta
Excellent	7	10	7	10
Good	6	6	6	6
Fair	5	4	5	4
Poor	1	1	1	1

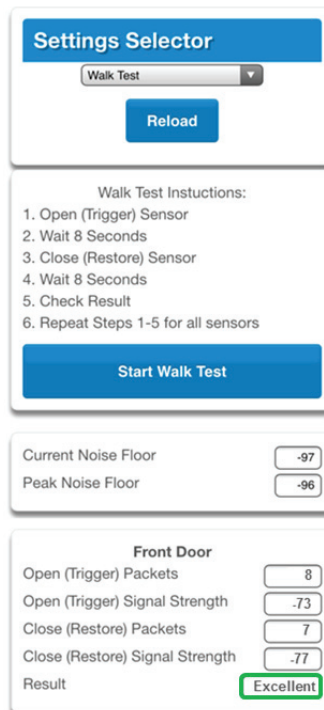

A180171

Setting up the UltraSync IP Cameras using the Côr Home Automation app

NOTE: The Camera App Setup Wizard will only work with Gen 2 Cameras (RS-3230, RS-3240 and RS-3250). For Gen 1 cameras (TVW-3120 and RS-3130) please reference Technical Supplement “Programming Camera” HA-6400-16SUP on the Côr Home Automation Product Dashboard page in HVACpartners.

- Login in the app as the installer and select **New Device Setup** with the guided directions.

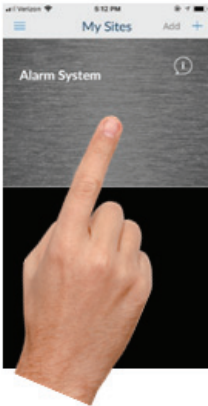

Click on the “Hamburger” menu.

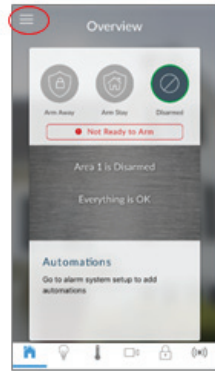

Click **NEW DEVICE SETUP** to setup the cameras.

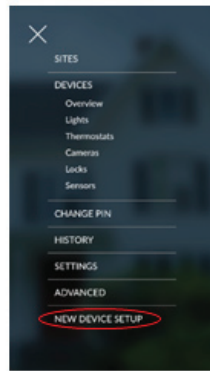

Click on the type of camera to setup.

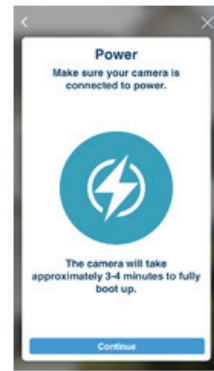

The camera could be blinking to indicate it is ready e.g. Link indicator on RS-3230 will blink a blue light.

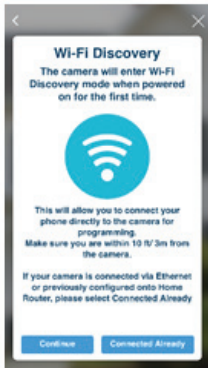

Select **Continue** if connecting camera wirelessly through the network.

Select **Connected Already** if connecting camera using hardware Ethernet cable (recommended for Outdoor cameras).



If connecting the camera wirelessly, go the the Wi-Fi settings on the smartphone or tablet to select the camera network i.e. RS-3230_xxxxxx then return to the app to continue setup.



The app will automatically transfer the wireless network that Côr panel is using. If the fields are blank then it is likely because the Côr panel is connected with the Ethernet cable in which case enter the login credentials for the same network the Côr panel is using.

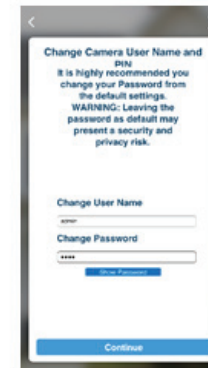

It is highly recommended that the password is changed. Make sure to record the new password.

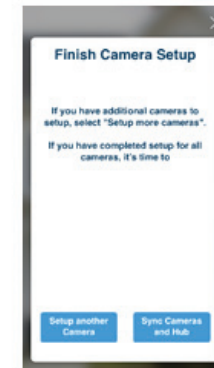

Click on **Sync Cameras and Hub**.

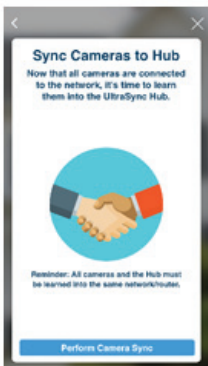

Click on pencil icon to rename camera.



Both Local and Server Connection should show as Connected.
If Server Connection is Not Connected then repeat the steps again. Also, check network location and if cameras need a firmware update.

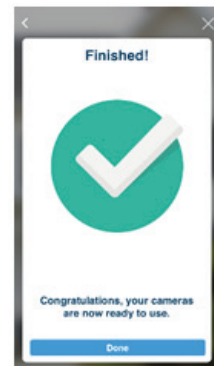

Step 8 — Handoff C r Home Automation app to the Homeowner

- Change the login credentials to the default User information

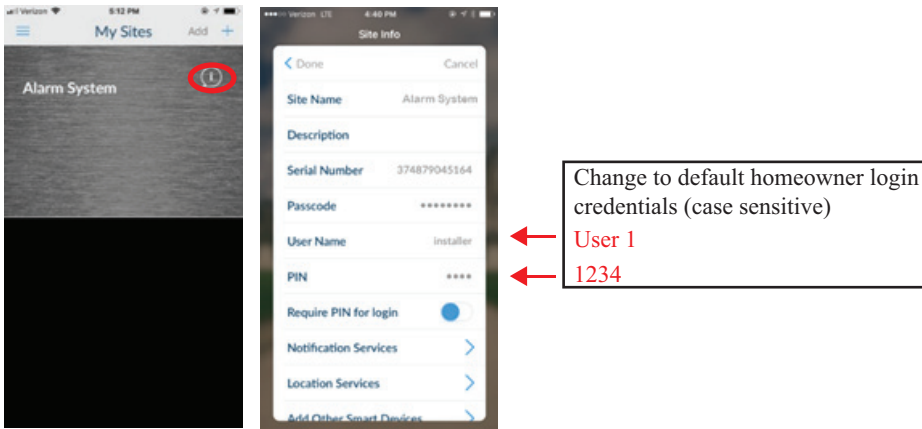

- Enable Notifications

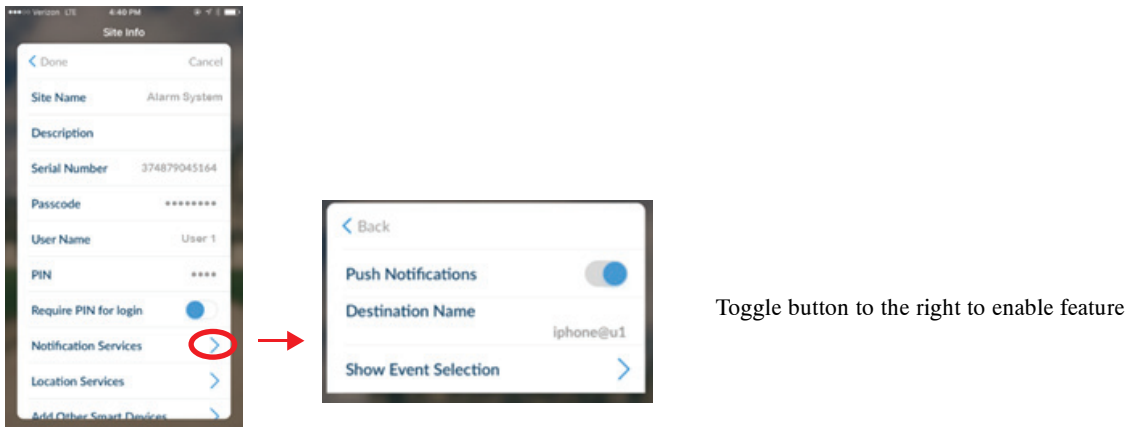

- Adding compatible thermostats and controls

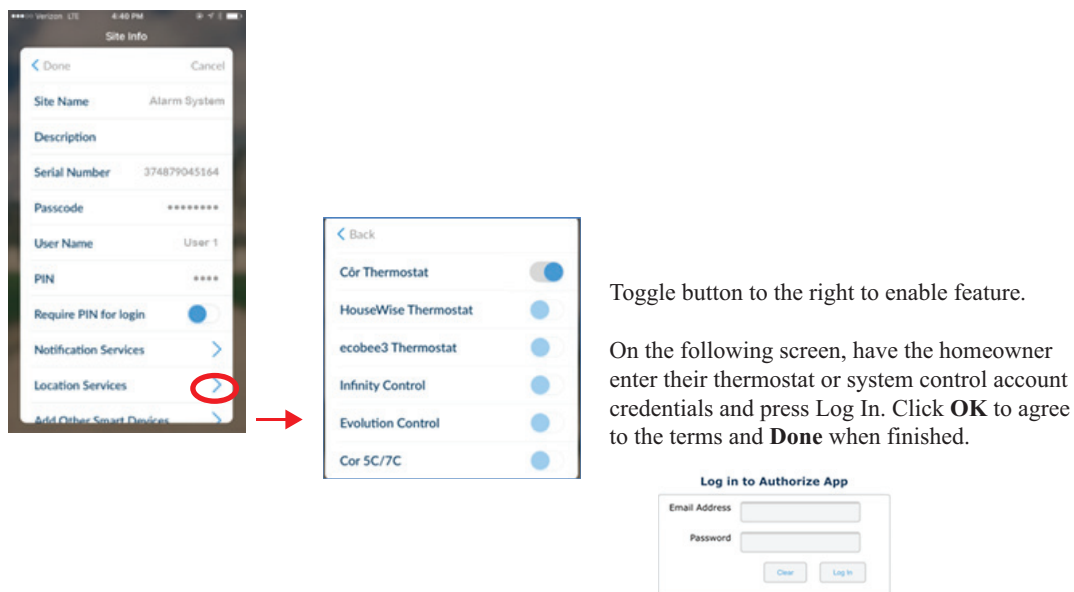

A180173

- Changing the default User Name login (*User 1*) and Password (*1234*)

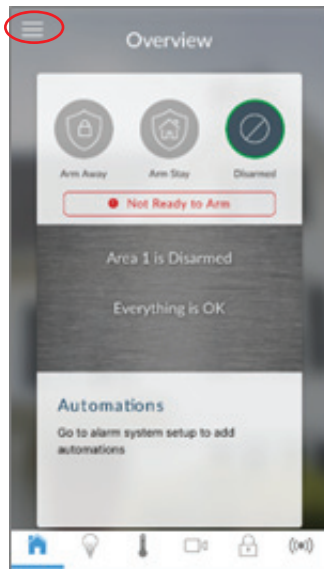
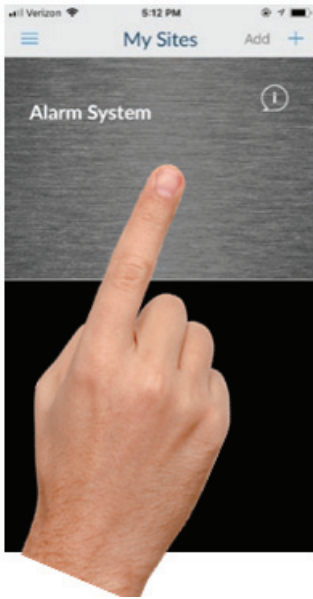

Click on the "Hamburger" menu.

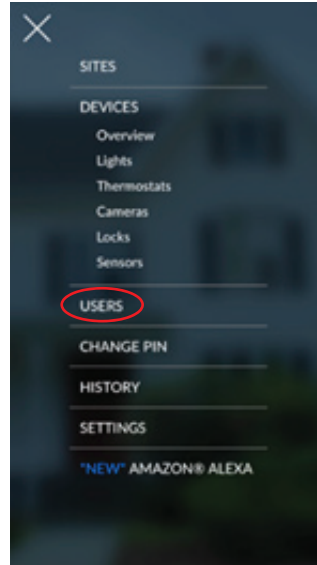

Click on the **USERS** menu.

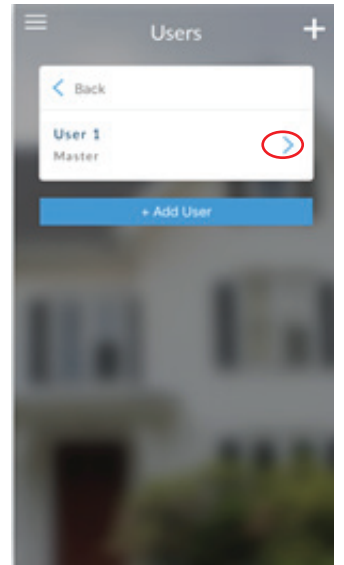

Click on the arrow to edit User 1 information.

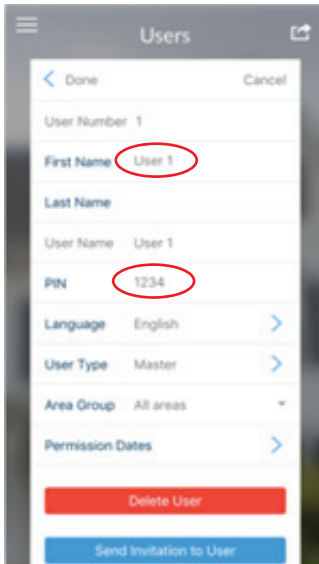

Edit the First Name (Last Name is optional and not required) and the PIN. Click **Done** when finished

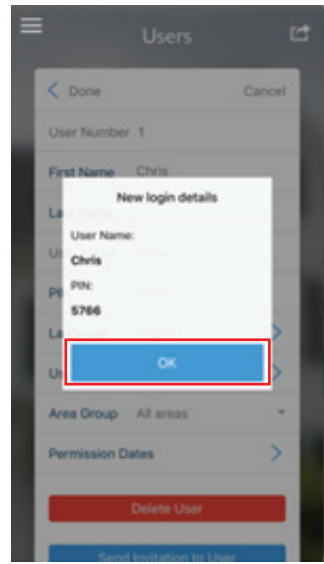

Click on **OK** to accept changes.

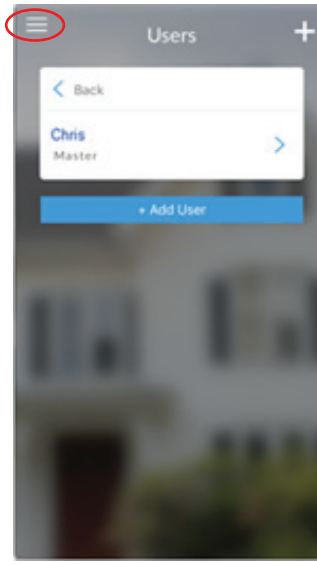

Click on the "Hamburger" menu.

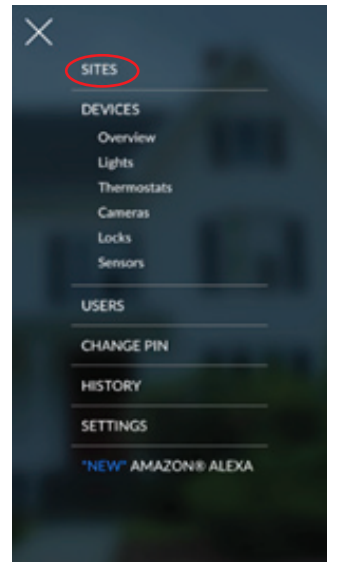

Click on **SITES** to exit the app.

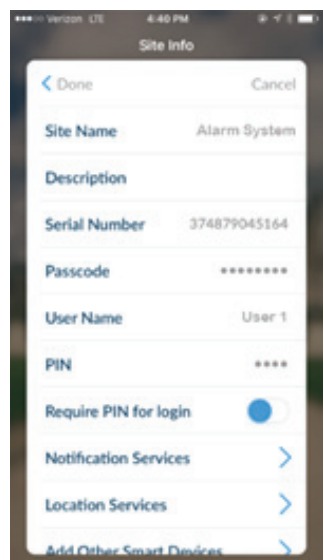
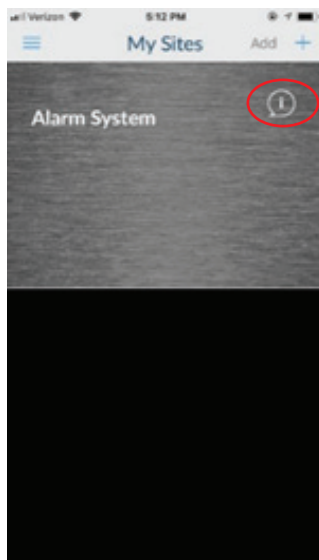

Change to newly created homeowner login credentials (case sensitive)
 Example:
 Chris
 5766

Congratulations!

This completes the setup. Have the homeowner go to the www.mycorhome.com site and download the latest User Guide that will show them various aspects of the C r Home Automation app including creating Automations and adding the Amazon Alexa Skill.



Homeowner's User Guide
www.mycorhome.com/support.

A180175

TROUBLESHOOTING

Côr Home Automation Error Messages

The Côr panel and app are two sources to pinpoint an issue.

On the Côr panel, simply press the **Status** button at the top center to listen to the error message. When the system is 'Ready', the Status button should be illuminated in a Green light.



A180176

<i>Fail to Communicate</i>	<p>This might be tied to the panel attempting to send a notification to a previous User that was setup in the app. Login to app and select Reporting and Notifications in the Settings menu. Select the Channel number that is mentioned in the error from the drop-down menu. Check if the information matches the User's smartphone that has the Notification Services enabled.</p>
<i>Control Ethernet Link Fault 2</i>	<p>Confirm the Côr panel is connected to the internet network by selecting Menu > 8 > installer PIN > Enter then press 6. The Côr panel will announce an IP Address if it is connected.</p> <p>Check your internet network connection to make sure it is working properly.</p>
<i>Sensor x, Loss of Wireless Supervision</i>	<p>Locate the troubled sensor location to ensure it is installed properly with a battery.</p> <p>Perform a Sensor Walk Test to validate the sensor is sending an acceptable signal to the Côr panel. Login the app as the installer and go to the Hamburger menu to select Settings > Walk Test.</p> <p>A 319.5 MHz repeater (part # 80-922-1) may be needed to help boost the signal.</p>

The other source where you could see an error message is on the Côr Home Automation app.

<i>Alarm system unreachable or passcode incorrect</i>	<p>Re-type your 8 digit Passcode in the Site Info screen</p> <p>If the error message continues to appear, confirm the Côr panel is connected to the internet network by pushing Menu > 8 > installer PIN > Enter then press 6. The Côr panel will announce an IP Address if it is connected. If it announces, 192.168.1.3 then Wi-Fi Discovery Mode is still enabled and needs to be disabled (Menu > 9 > installer PIN > Enter then press 8).</p> <p>Check your internet network connection to make sure it is working properly.</p> <p>If the Côr panel is connected directly to the homeowner's router using an Ethernet wire, make sure Ethernet (or Wi-Fi) is enabled. On the Côr panel, select Menu > 9 > installer PIN > Enter then press 7. Listen for the appropriate setting.</p>
<i>Invalid Response from Servers</i>	<p>Confirm the Côr panel has the most recent updated Firmware version.</p>
<i>Too many login requests</i>	<p>Confirm the Côr panel is connected to the internet network by selecting Menu > 8 > installer PIN > Enter then press 6. The Côr panel will announce an IP Address if it is connected.</p> <p>This error would also display after 3 attempts with the wrong 8 digit Web Access passcode. Every subsequent failed attempt will double the lockout time.</p> <p>Check your internet network connection to make sure it is working properly. Also, you can clear the lockout by Arming and Disarming from the Côr panel.</p>

<p><i>Error Connecting</i></p>	<p>Confirm the Côt panel is connected to the internet network by selecting Menu > 8 > installer PIN > Enter then press 6. The Côt panel will announce an IP Address if it is connected.</p> <p>Disable your Wi-Fi connection on your smartphone and attempt to login the app again.</p> <p>Check your internet network connection to make sure it is working properly..</p>
<p><i>Camera unreachable or authentication fail</i></p>	<p>Verify the specific camera is connected to a power source and the internet network is online.</p> <p>Check the internet network of the Côt panel matches the network that the camera will be using. Login the Côt app as the installer and look at the Wi-Fi information by going to <i>Hamburger</i> menu > Settings > Network.</p>
<p><i>Error connecting</i> <i>No response from camera server</i></p>	<p>Check to see if the video event from the specific camera is connected to a power source; an internet network; and viewable on the Côt Home Automation app.</p>
<p><i>Video Not Available</i></p>	<p>When trying to play back a previous recorded video under History, the video will not play.</p> <p>Depending on the UPLOAD speed of the Internet Service Provider (ISP), the video may take some time to stream on the app. Some possible correction to improve playback include the following:</p> <ul style="list-style-type: none"> • Reduce the video bandwidth by changing some settings under the Camera video screen. This would include lowering the Frames per Second (FPS) to 6 and not selecting HD. • Connect the Côt panel directly to the homeowner’s router using an Ethernet connection (versus W-Fi). Make sure to enable Ethernet on the panel by selecting Menu > 9 > installer PIN > Enter then press 7. Listen for the appropriate setting. • Download the latest Firmware to the camera when video viewing is available in the app but not during playback from the History.
<p><i>There is an audible alarm triggered in the camera</i></p>	<p>Log into TruVision using the camera IP address in Internet Explorer and go to Events > Alarm Output. Make sure Alarm is not set.</p> <p>Go to Events menu > Exception tab. In the “Exception Type” dropdown for HDD Error and make sure <i>Audible Warning</i> is not checked.</p> <p>Do the same for the other three options under the dropdown. Make sure <i>Audible Warning</i> is not set on any.</p> <p>Click Save after each change.</p>

For additional Technical Support, please call Interlogix at (855) 286-8889
Option 2 > Option 1 > Option 7
Hours of Operations: **8:00 am – 8:00 pm EST**

APPENDIX A

Other Sensor Setup Reference

Learn the SDX-135Z Wireless Smoke Detector with Heat/Freeze Sensor to the Côt Panel

NOTE: In this setup, the device will be manually entered into the system as a Smoke and a Freeze sensor. Alternatively, the device can be learned into the system.



A180177

- Go to **Settings** and select **Sensors** from the dropdown menu under Settings Selector
- Select **Sensor to Configure** for the next available slot i.e. “5 Sensor”



Name the sensor

Select **Fire Alarm**

Select **Fire** under Sensor Option

Enter the unique TX ID from the label on the Smoke Detector
Leave as **Tamper**

Name the sensor for the panel voice annunciation

Click **Save** at the top when finished

A180178

Learn as a Low Temperature (Freeze) Sensor

- Select **Sensor to Configure** for the next available slot i.e. “6 Sensor”



Name the sensor.

Select **24 Hour Audible**.

Select **Low Temp** under Sensor Option.

Enter the second unique TX ID from the label on the Smoke Detector.
Check as **Tamper**.

Name the sensor for the panel voice annunciation.

Click **Save** at the top when finished.

A180179

Learn the TX-6310-01-1 CO Detector to the Côt Panel



A180180

- Go to **Settings** and select **Sensors** from the dropdown menu under Settings Selector
- Select **Sensor to Configure** for the next available slot i.e. “5 Sensor”

A180181

- Click on the **Learn** button
- Install the batteries
- Trip the wall tamper by removing the alarm body from the mounting plate
- A message will appear that a New Device Found

Name the sensor

Select **CO Detector**

Select **Gas Detected** under Sensor Option

Leave **Tamper** unchecked in the event batteries need to be replaced

Name the sensor for the panel voice annunciation

Click **Save** at the top when finished

A180182

Learn the SLX-AD-T3 Firefighter audio Detector to the Côt Panel



A180183

- Go to **Settings** and select **Sensors** from the dropdown menu under Settings Selector
- Select **Sensor to Configure** for the next available slot i.e. “5 Sensor”

A180184

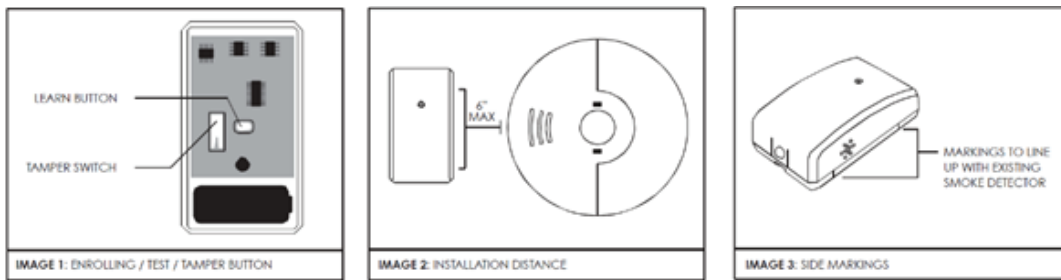

A180185

- Click on the **Learn** button
- Remove the top cover from the main body and install the battery
- Press the Learn Button
- A message will appear that a New Device Found

Name the sensor

Select **Fire Alarm**

Select **Fire** under Sensor Option

Leave **Tamper** unchecked in the event batteries need to be replaced

Name the sensor for the panel voice annunciation

Click **Save** at the top when finished

A180186

Learn the 60-873-95 Glass Break Sensor to the Côt Panel



A180187

- Go to **Settings** and select **Sensors** from the dropdown menu under Settings Selector
- Select **Sensor to Configure** for the next available slot i.e. “5 Sensor”

A180188

- Click on the **Learn** button
- Remove the top cover from the main body and install the battery
- Press the Learn Button
- A message will appear that a New Device Found

Name the sensor

Select **Instant**

Select **Bypass** under Sensor Option

Leave **Tamper** unchecked in the event batteries need to be replaced

Name the sensor for the panel voice annunciation

Click **Save** at the top when finished

A180189

Learn the TX-E401 Garage Door Tilt Sensor to the Côt Panel



A180190

- Go to **Settings** and select **Sensors** from the dropdown menu under Settings Selector
- Select **Sensor to Configure** for the next available slot i.e. “5 Sensor”

A180191

- Click on the **Learn** button
- Remove the top cover from the main body and install the battery
- Press the tamper (limit switch) button
- A message will appear that a New Device Found

Name the sensor

Select **Entry Exit Delay 1 Auto-Bypass**

Select **Bypass** under Sensor Option

Leave as **Tamper**

Name the sensor for the panel voice annunciation

Click Save at the top when finished

A180192

Learn the 600-1064-95R or TX-E101 Key Fob to the Côt Panel



A180193

- Go to Settings and select **Keyfobs** from the dropdown menu under Settings Selector
- Select **Keyfob to Configure** for the next available slot if another Key Fob has already been added i.e. “66 KeyFob”
- Click on the **Learn** button
- Press the Lock and Unlock button on the Key Fob at the same time
- A message will appear that a New Device Found



A180194



A180195

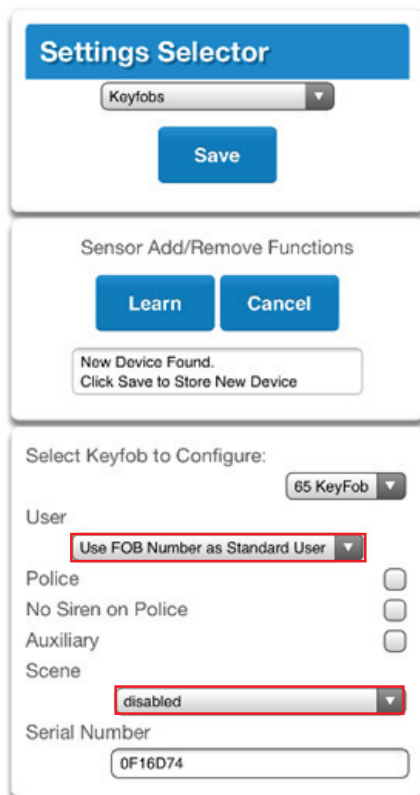

User - Assign Key Fob to a specific user if desired so when system is armed or Unarmed then notification will let you know who triggered the event.

Assign a Scene from the drop down to trigger an Automation when the Light Bulb button is pressed on the Key Fob. Note: automation scene will need to be programmed for the desired action.

Click **Save** at the top when finished.

A180196

NOTE: The check boxes are used to link to a Security Central Stations.

Adding the UX-TOUCH01 Secondary Touchscreen Panel with the Côr Panel



A180197

Needed for Installation

- Latest firmware SR 4.1 or higher on the Côr Panel
- Password for Homeowner's internet service



1. Enter installer PIN and click **DONE**

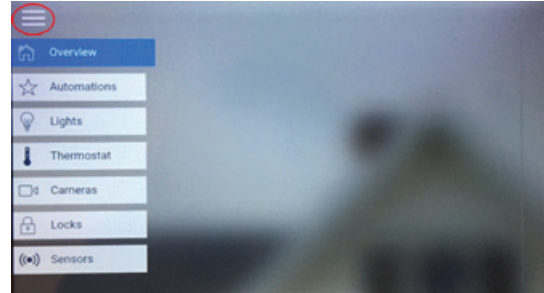

2. Once logged in, click on the Hamburger menu

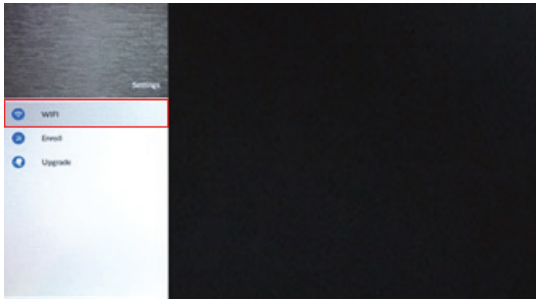

3. Click on **WiFi**

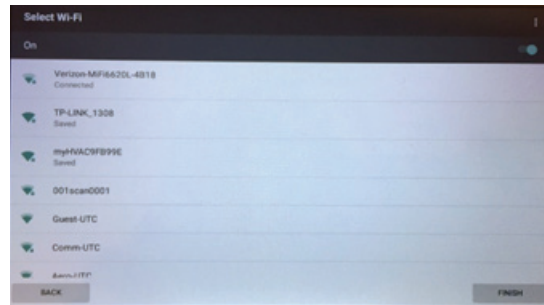

4. Select the homeowner's network that the Côr panel is also using and enter the password

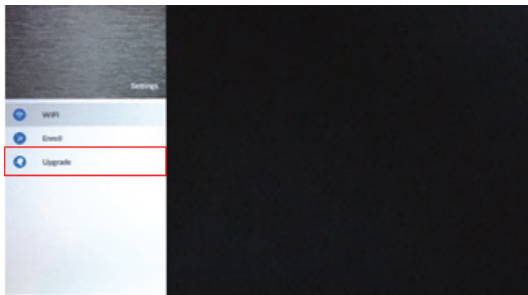

5. Click on **Upgrade**



6. Select the latest firmware for the touchscreen to download

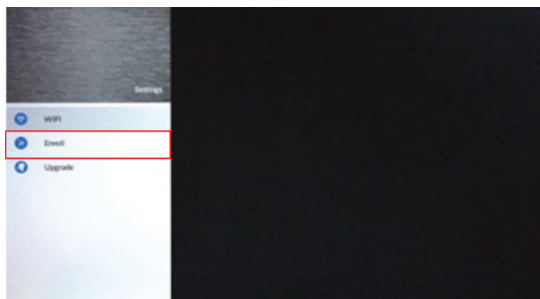

7. Click on **Enroll**

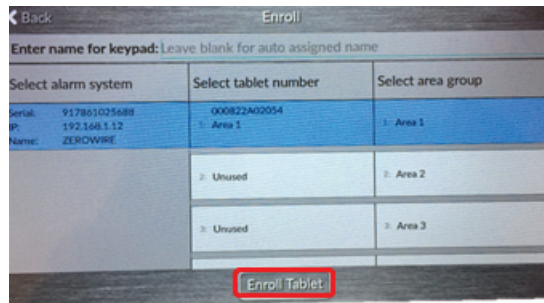

8. Tap available fields to assign tablet number and area group. Click on **Enroll Tablet** when finished.

A180198

Defaulting the Touchscreen

Power down the touchscreen then PRESS and HOLD **Power** and **UP Volume** at the same time.

Adding a 319.5 MHz Repeater (80-922-1) to the Côt Panel

The 80-922-1 Repeater Kit is a dual-antenna receiver and transmitter that increases the distance that a 319.5 MHz sensor can be installed from the Côt panel.

Assembly of the Repeater Kit is required and instructions are provided.

- Insert the antennas into the antenna shrouds
- Gently slide the top of the circuit board under the two top latches
- Snap the circuit board in at the bottom latch to secure it in place
- Connect DC power to the OEM transceiver module using 2 mm power jacks (center positive) or connect flyleads to the terminal block as labeled on the board

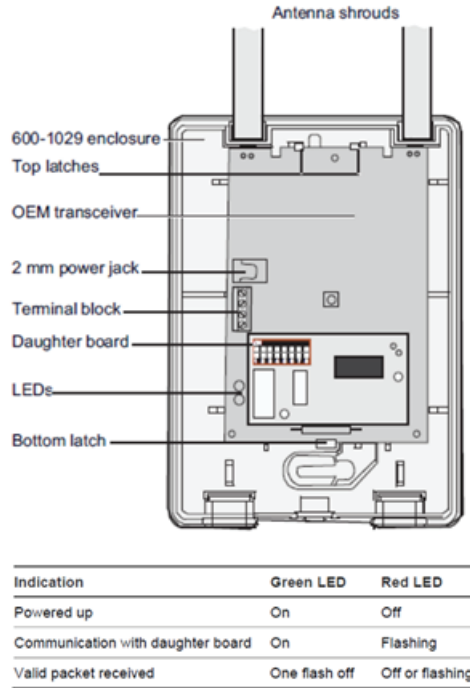

A180199

Once assembled, place the repeater unit between the furthest 319.5 MHz sensor and the Côt panel. In most cases, the furthest sensor would be the one that is issuing a 'Loss of Supervision' error on the Côt panel. More than one repeater can be installed in the home or small business.

Wi-Fi® is a registered trademark of the Wi-Fi Alliance Corporation
 Z-Wave® is a registered trademark Sigma Designs, Inc. and/or its subsidiaries.
 Android and Google Play are trademarks of Google Inc.
 App Store is a service mark of Apple Inc.
 Amazon's trademark is used under license from Amazon.com, Inc. or its affiliates.